



## T&D Fittings

### Turnbuckles

All eye-eye, jaw-eye and jaw-jaw turnbuckles meet or exceed Federal Specifications FF-T-791b, Type 1, form 1, Class 4, 7 and 8. All turnbuckles are drop forged from high strength special bar quality steel, and heat treated for added strength and ductility. All forgings are hot dip galvanized per ASTM A-123. All bolts, nuts and lock nuts are hot dip galvanized per ASTM 1-153. Jam lock nuts are supplied with all types of end fittings. All turnbuckles bodies have hex ends. All fittings, such as shackles, links and yokes, used for attachment of turnbuckles to other parts, should be checked to insure clearance.

Turnbuckles may be ordered with jaw or eye fittings by adding "JE" for jaw-eye, "JJ" for jaw-jaw or "EE" for eye-eye to the catalog number (i.e., 3790EE).

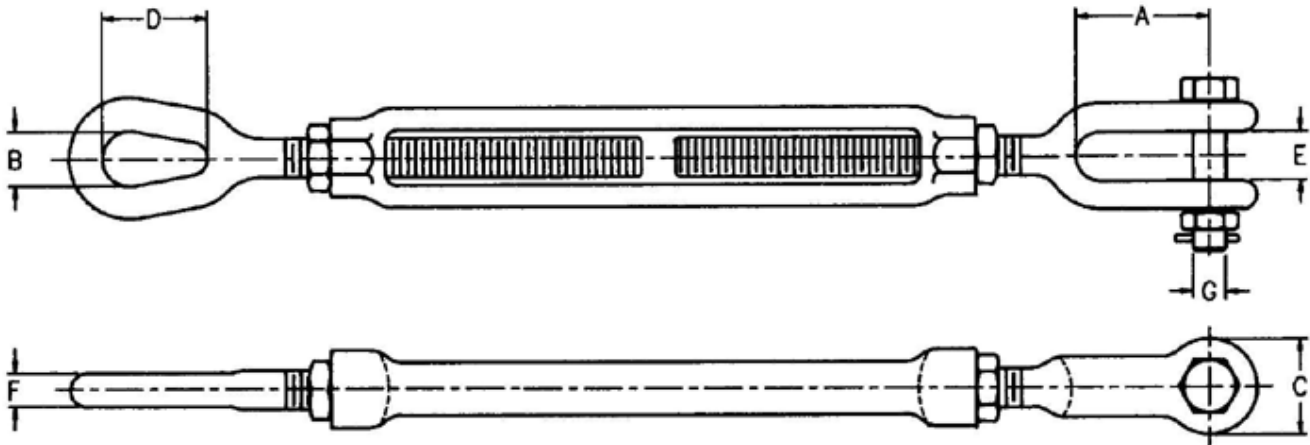

CATALOG NUMBER	SIZE AND TAKE UP	DIMENSIONS (INCHES)							JAW - JAW		JAW - EYE		EYE - EYE		ULTIMATE STRENGTH (LBS)
		A	B	C	D	E	F	G	CLOSED	OPEN	CLOSED	OPEN	CLOSED	OPEN	
3780	1/2 x 6	1 1/4	3/4	1 1/8	7/16	5/8	7/16	3/8	9 5/8	15 5/8	11 3/32	17 3/32	12 9/16	18 9/16	10,500
3781	1/2 x 9	1 1/4	3/4	1 1/8	7/16	5/8	7/16	3/8	12 5/8	21 5/8	14 3/32	23 3/32	15 9/16	24 9/16	10,500
3782	1/2 x 12	1 1/4	3/4	1 1/8	7/16	5/8	7/16	3/8	15 5/8	27 5/8	17 3/32	29 3/32	18 9/16	30 9/16	10,500
3783	5/8 x 6	1 5/8	29/32	1 3/8	1 3/4	3/4	1/2	1/2	13 1/4	19 1/4	13 9/16	19 9/16	1 7/8	19 7/8	16,000
3784	5/8 x 9	1 5/8	29/32	1 3/8	1 3/4	3/4	1/2	1/2	16 1/4	25 1/4	16 9/16	25 9/16	16 7/8	25 7/8	16,000
3785	5/8 x 12	1 5/8	29/32	1 3/8	1 3/4	3/4	1/2	1/2	19 1/4	31 1/4	19 9/16	31 9/16	19 7/8	31 7/8	16,000
3786	3/4 x 6	1 13/16	1 1/32	1 11/16	2 1/8	15/16	5/8	5/8	14 1/4	20 1/4	14 7/8	20 7/8	15 1/2	21 1/2	25,000
3787	3/4 x 9	1 13/16	1 1/32	1 11/16	2 1/8	15/16	5/8	5/8	17 1/4	26 1/4	17 7/8	26 7/8	18 1/2	27 1/2	25,000
3788	3/4 x 12	1 13/16	1 1/32	1 11/16	2 1/8	15/16	5/8	5/8	20 1/4	32 1/4	20 7/8	32 7/8	21 1/2	33 1/2	25,000
3789	3/4 x 18	1 13/16	1 1/32	1 11/16	2 1/8	15/16	5/8	5/8	26 1/4	44 1/4	26 7/8	44 7/8	27 1/2	45 1/2	25,000
3790	7/8 x 12	2 1/8	1 9/32	2	2 3/8	1 1/8	3/4	3/4	21 5/8	33 5/8	22 1/8	34 1/8	22 5/8	34 5/8	35,000
3791	7/8 x 18	2 1/8	1 9/32	2	2 3/8	1 1/8	3/4	3/4	27 5/8	45 5/8	28 1/8	46 1/8	28 5/8	46 5/8	35,000



CATALOG NUMBER	SIZE AND TAKE UP	DIMENSIONS (INCHES)							JAW - JAW		JAW - EYE		EYE - EYE		ULTIMATE
		A	B	C	D	E	F	G	CLOSED	OPEN	CLOSED	OPEN	CLOSED	OPEN	STRENGTH (LBS)
3792	1 x 12	2 1/2	1 15/32	2 5/32	3	1 3/16	7/8	7/8	23 9/32	35 9/32	24	36	24 3/4	36 3/4	45,000
3793	1 x 18	2 1/2	1 15/32	2 5/32	3	1 3/16	7/8	7/8	29 9/32	47 9/32	30	48	30 3/4	48 3/4	45,000
3794	1 x 24	2 1/2	1 15/32	2 5/32	3	1 3/16	7/8	7/8	35 9/32	59 9/32	36	60	36 3/4	60 23/4	45,000
3795	1 1/4 x 12	3	1 27/32	2 7/8	3 9/16	1 3/4	1 1/8	1 1/8	24 5/8	36 5/8	26	38	28 1/8	39 1/8	67,500
3796	1 1/4 x 18	3	1 27/32	2 7/8	3 9/16	1 3/4	1 1/8	1 1/8	30 5/8	48 5/8	32	50	33 1/8	51 1/8	67,500
3797	1 1/4 x 24	3	1 27/32	2 7/8	3 9/16	1 3/4	1 1/8	1 1/8	36 5/8	60 5/8	38	62	39 1/8	63 1/8	67,500
3798	1 1/2 x 12	3 11/32	2 1/8	3 1/8	4 1/8	2 3/16	1 1/4	17 1/6	28 1/8	40 1/8	30 9/16	42 9/16	31 1/4	43 1/4	105,500
3799	1 1/2 x 18	3 11/32	2 1/8	3 1/8	4 1/8	2 3/16	1 1/4	17 1/6	34 1/8	52 1/8	36 9/16	54 9/16	37 1/4	55 1/4	105,500